



## Combi Lock Troubleshooting - TSA Big Dial Twist 'n' Set Padlock (358 / 358KK)

Combination not working? Follow these useful tips to help open your lock:

**FOR SECURITY REASONS, THE TWIST 'N' SET LOCK'S SHANK MUST BE PULLED UP FIRMLY IN ORDER TO RELEASE IT.**

### TIP 1

It is possible that your combination was set while looking at your lock from the rear, rather than from the front. If this should happen, follow these simple steps to help open your lock:

1. Flip lock over so you are looking at it from the back - you will notice there is no 'Set Line' on the rear face (see fig. 2)
2. Set lock to last known combination ensuring that each dial 'clicks' into position.
3. Try to open your lock. If successful, reset your combination using the Lock Reset Instructions below.

### TIP 2

It is possible that after setting your combination code, Dial C may become stiff and difficult to scramble. If this should happen, follow these simple steps to help rectify the problem:

1. With the 'Set Line' facing you and your lock no longer in 'Set Mode' (see fig. 3), gently increase Dial C by one digit. **Important Note:** Ensure the dial 'clicks' into position.
2. Then, gently decrease Dial C by two digits. This should sufficiently loosen the dial and allow you to scramble your combination.

### Helpful Hints

- Select each number carefully and line it up correctly with the 'Set Line'.
- Make sure that each dial 'clicks' into position to avoid becoming locked out again.
- Once reset, close lock, scramble dials and test your combination before attaching to suitcase or bag.

### Lock Reset Instructions

Once open, be sure to reset your combination regardless of whether or not you choose the same 3 digit code. With the 'Set Line' on your lock facing you, follow these simple steps:

1. Pull down and rotate base section 90° anti-clockwise, Set Indicator Visible
2. Set new code
3. Rotate base section 90° clockwise. Pull Shank up to test new code, relock

Figure 1. (Front Face)

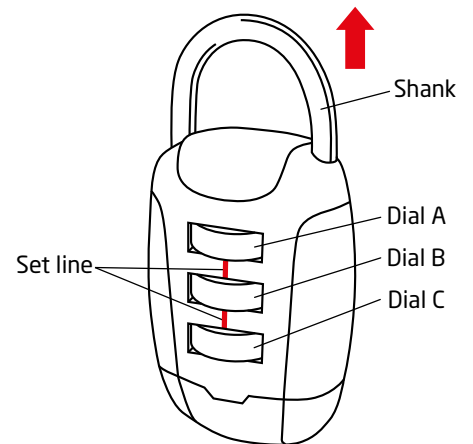

Figure 2. (Rear Face)

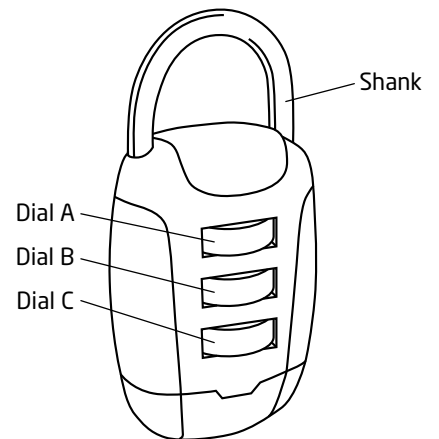
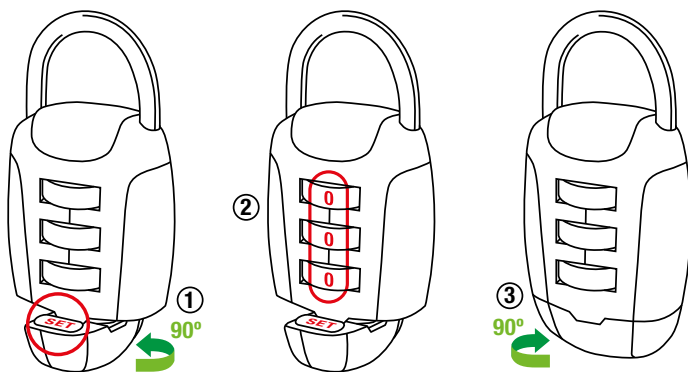
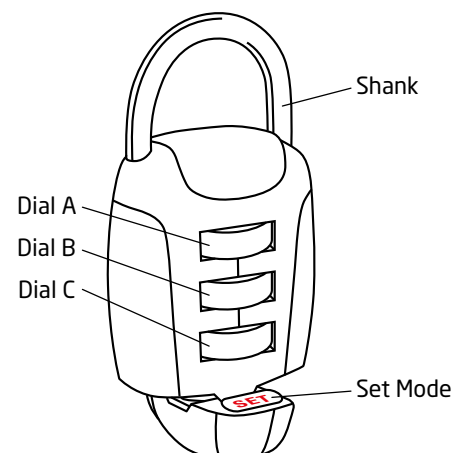

Figure 3.



**IMPORTANT:** Ensure **Set Indicator** is visible when setting code